

# Power Pedestal with Tabletop Decal

## Product Parts

- 1 - Top
- 2 - Base
- 3 - Vertical Poles (x6)
- 4 - Charging Cables (x3)  
Lightning, Micro USB, USB Type-C
- 5 - Power Adapter (x2)
- 6 - Graphic Wrap
- 7 - Graphic Decal

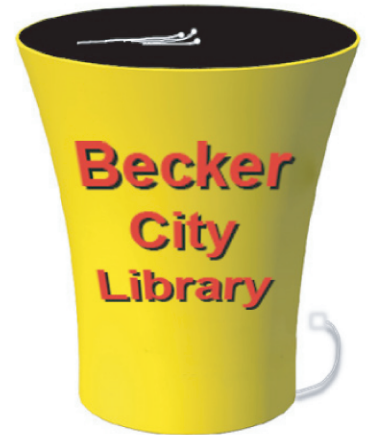
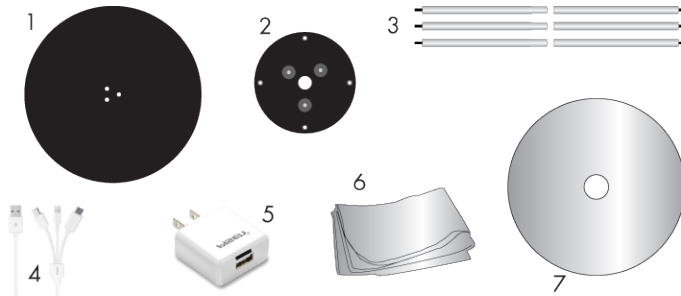

## Display Set-Up

### Step 1

Match and combine the Vertical Poles (3) to each other, to the Base (2) and to the Top (1).



### Step 2

Thread the Charging Cables (4) through the Base (2) and Top (1). Cables can go through any of the holes, but should be secured by attaching the cable hanger band to prevent them falling into the display.

### Step 3

The Graphic Wrap (6) has a gasket that fits into grooves on both the Top and Base. The more narrow end of the graphic goes to the base and can be identified with the fabric tab. Push the graphic into the Base (2) first and then stand the display upright.

### Step 4

Push the Graphic's (6) gasket into the Top's groove.

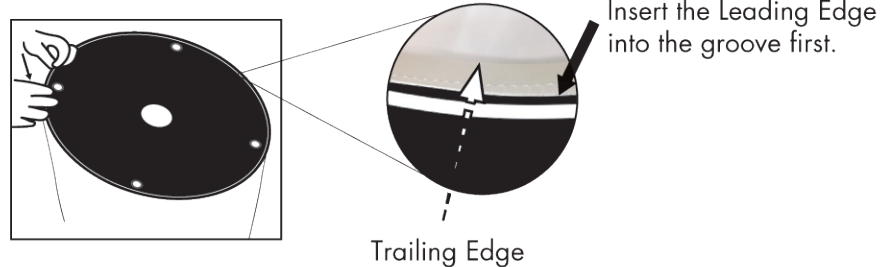

To remove the Graphic (6), pull the fabric tab on the bottom for an easy start.

### Step 5

To apply the Graphic Decal (7) on the Top (1), peel a small strip of liner from the back side of the decal and crease the liner. Be careful not to touch the adhesive. Orient the decal, gently apply the exposed adhesive surface, and slowly continue to apply the graphic, removing the liner as you are applying. Do not remove the entire liner before applying, as this may cause excessive air bubbles. Use a soft rubber roller or squeegee on the surface of the graphic to remove any air bubbles, and make sure it's fully adhered to the surface. It can be repositioned.

To remove the Graphic Decal (7), lift one corner and pull it back slowly.

## Storage & Care

Store all parts in a cool, dry place. To clean, wipe the frame with a damp cloth. Machine wash the Graphic on a cold, gentle cycle and air-dry only. Never dry clean.